

2-axis mirror tilting system

series PSH x/2

Handling instructions

To avoid any damage during mounting and installation please take care about the following instructions

The mounting-clamp can be ordered as accessories with part number **K-190-02**.

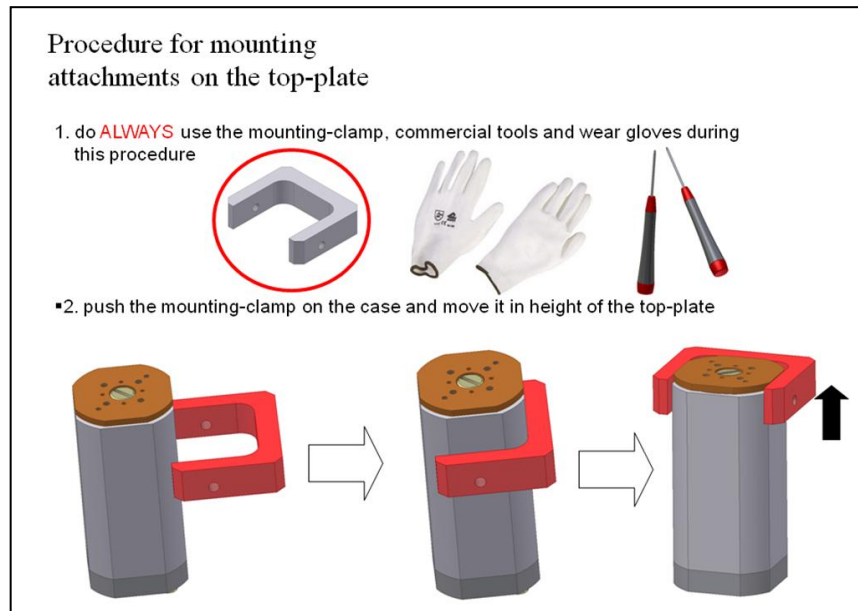

- Please avoid shock impacts and shaking of these elements

- Please avoid shear and torque forces by mounting and during use

- The max. Torque force by mounting of components shouldn't exceed 20Ncm

- Make sure that push- and pulling forces during dynamical use are below the given pre-load of the system

Special notice for using piezoelectrical elements series PX, PZ, PXY, TRITOR, PSH and PZS from piezosystem jena

These elements have integrated solid-state flexure hinges for motion transmission. Depending on the special performance, the element can be preloaded and can work dynamically. Elements, especially mirror mounts of the series PSH, are suited for dynamical applications and will not be damaged if handled correctly.

But please note:

The mounting and handling of these elements should be done very carefully to avoid plastic bending of the hinges which will damage the elements. Most of these elements consist of a ground or bottom plate that will be attached by screws. The top plate of the elements makes the motion. Mirrors or other elements to be moved can be mounted on the top plate.

The mounting can be accomplished using screws or adhesives (depending on the element and on the application). However, avoid forces between the top plate, the middle part and the bottom element (tensile, shear, strain or torque forces). These forces can cause damage to the elements. Do not open the elements or remove the bottom and top plates. Elements for dynamical applications are fixed using adhesives and when opening the elements forces occur which will bend the hinges and damage the element.

If it is necessary to use forces for mounting be sure that these forces can not occur between the parts of the piezoelement (e.g. by clamping).

If it is necessary to remove a plate, please contact us.

If the element is handled incorrectly or if the element has been opened, the warranty will be lost.

Please note:

Keep the actuator away from a humid environment. After receiving please store the actuator in a dry room (an air conditioned room is preferable) for at least 24 hours or put it in a desiccator for at least two hours before use.

After long storage a depolarization of the piezoactuator might happen. Therefore a slow increasing of the voltage is recommended. Under no circumstances should the actuator be operated with 130V immediately. *piezosystem jena* recommends an increase to maximum voltage in not less than 10 seconds.

Rights reserved to change specifications as progress occurs without notice!

phone: +49 (3641) 66880 • fax: +49 (3641) 668866 • info@piezोजना.com • www.piezोजना.com